

MAGNUM HYDRAULIC BREAKER

FEATURES

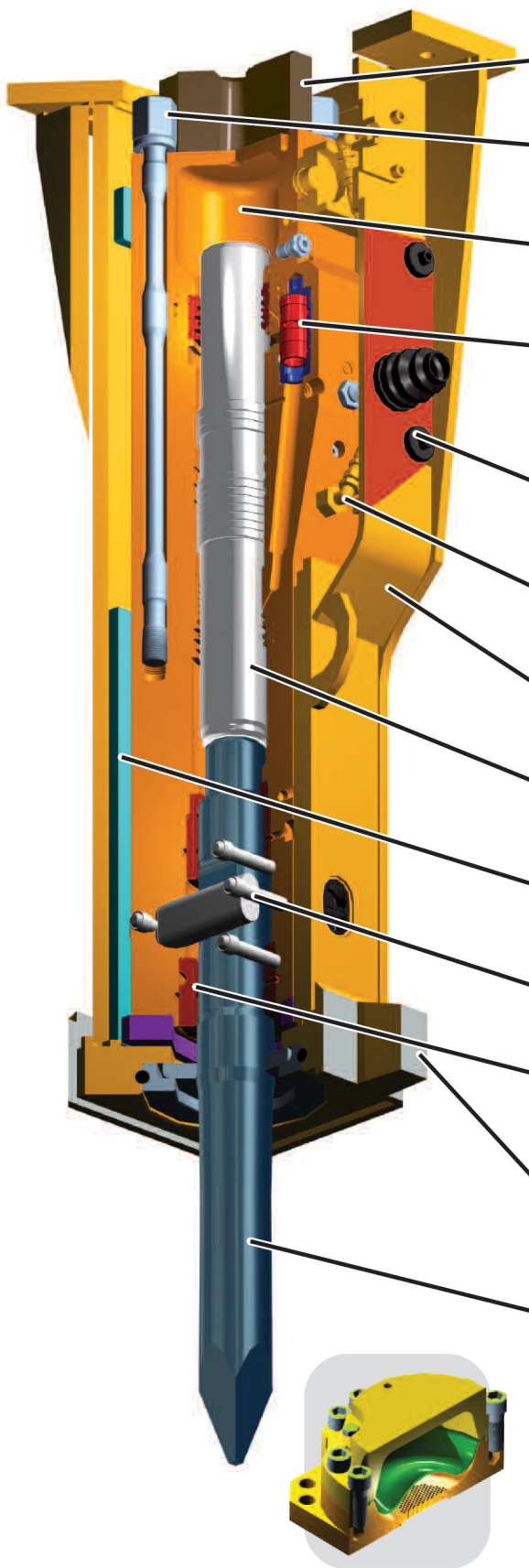

- 1 Shock Mount** – Heavy duty rubber shock mount absorbs power cell recoil minimizing machine wear and improves operator comfort.
- 2 Through Bolt** – Designed to reduce internal stresses between powercell components resulting in a longer service life.
- 3 Nitrogen Gas Chamber** – Compressed nitrogen gas provides energy to the cylinder downstroke resulting in less demand to the carrier's hydraulic system.
- 4 Integrated Valve Design** – Integrated Valves on all hammer models provide better durability and performance by reducing the number of parts and minimizing pressure losses through external valves.
- 5 Light-Weight Cover** – Reduces noise and provides dust protection.
- 6 Lubrication Port** – Compatible with automatic lubrication systems to ensure the chisel and bushing area are adequately greased.
- 7 Enclosed Box Design** – The full box enclosure protects the powercell minimizing hammer maintenance and reduces noise. Standard on all models.
- 8 Piston** – Long piston stroke minimizes recoil, reduces vibration and provides greater impact energy.
- 9 Wear Plates** – As many as eight abrasion resistant wear plates maintain the position of the powercell within the box while reducing noise and vibration.
- 10 Tool Retaining Bars** – Allows for easy removal of tool. Dual retaining bars on Models 309-350.
- 11 Tool Bushing** – Field replaceable slip fit bushing, easy to replace resulting in reduced maintenance costs.
- 12 Hardened Rock Claw** – Hardened steel for maximum service life designed to assist the positioning of material to be broken.
Quarry Box Design – on Models 313-350.
- 13 High Quality Working Tool** – High grade heat treated steel.

High Pressure Accumulator RHB 320 and larger –

- Eliminates pressure fluctuation
- Increases impact power